

BOOMERANG STRASSEN SHOPPING CENTER

The Office and Retail site located Route d'Arlon in Strassen has been redeveloped into a retail park concept that, besides shops, also a/o includes a restaurant and a business center. This site is the largest retail park at the entrance of the city of Luxembourg.



UNITS

Offices	712,01 sqm
Retail	21.215,34 sqm
Parking	435 u

LOCATION

Route d'Arlon 2, LU-8008 Strassen

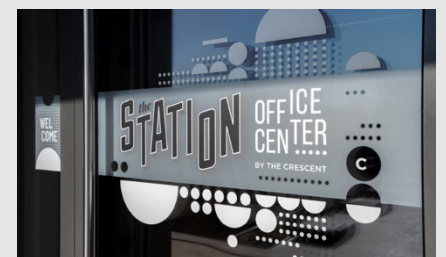

AVAILABILITY

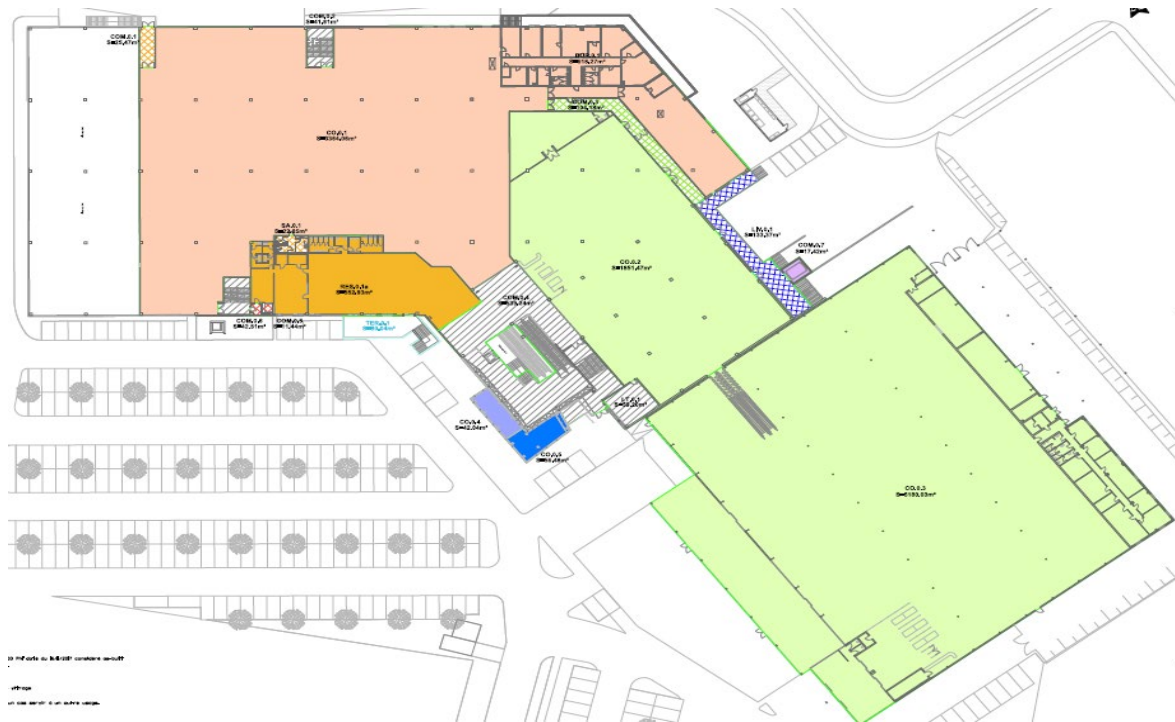

CONTACT INFORMATION

Mr. William Moulin

Tel: + 352 26 95 47 22

Email : william.moulin@nextensa.eu

This offer is subject to changes without prior notice. Prices listed are target prices.

Please contact our offices for further information. Published on January 2022